

Lite-Trap™ SMT Wire-to-Board Connector System, Push-Button Type



Standard, Mini and Bottom-Entry Types

Ideal for thin LED lighting-module applications, Molex's Lite-Trap™ SMT wire-to-board connectors offer easy wire removability and low-profile top-and-bottom entry styles for reduced shadowing

Features and Benefits

Low-profile top-and-bottom entry styles	Provide reduced shadowing effects for LED applications
User-friendly push-button latch	Ensures easy wire extraction
Low wire insertion and high wire retention forces	Enables easy wire insertion; provides secure contact retention
Long wire insulation design	Provides stable wire placement for additional contact assurance
Compact industry-standard PCB pattern layout	Saves space and is drop-in compatible with certain competitive products
Wire stopper feature	Facilitates correct wire insertion depth placement
Dual-contact gate-style terminal design	Provides secure electrical contact and high wire-retention force

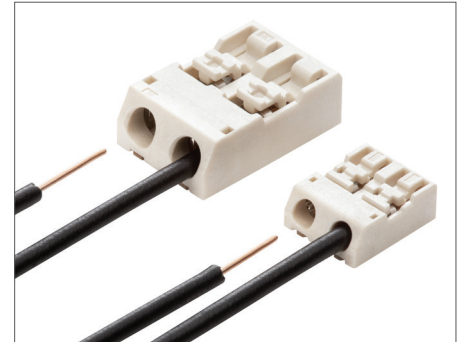

Standard and Mini Lite-Trap™ connectors

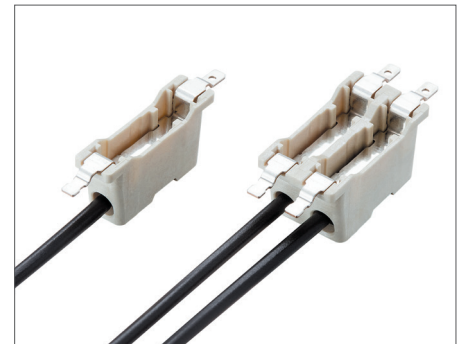

Bottom-Entry Lite-Trap™ Connector

Applications

Lighting

- Down Light
- Strip Light

Factory Automation Equipment

Consumer Electronics

Any application requiring an easy-to-use wire insertion/extraction method

LED Down Lighting

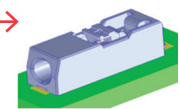
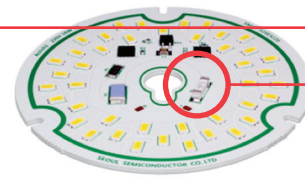

1 Circuit

LED Strip Lighting

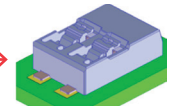
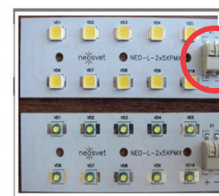
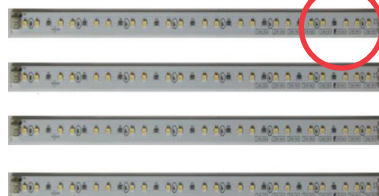

2 Circuit

Lite-Trap™ SMT Wire-to-Board Connector System, Push-Button Type



Standard, Mini and Bottom-Entry Types

Specification

REFERENCE INFORMATION

Packaging: Embossed Tape
 Use With: Solid or stranded wire
 Designed In: Millimeters
 RoHS: Yes
 Halogen Free: Yes
 Glow Wire Compliant: No

ELECTRICAL

Voltage (max.): 300V (Mini: 160V; Bottom-Entry 320V)
 Current (max.): 9A (Mini: 3.0A)
 Contact Resistance: 10 milliohms max.
 Dielectric Withstanding Voltage: 1,600 VAC;
 Mini: 1,320 VAC; Bottom Entry: 1,640 VAC
 Insulation Resistance: 1,000 Megaohms min.

MECHANICAL

Wire Insertion Force: 10.0N max.
 Wire Retention Force:
 Standard:
 AWG 24-28: 28N min.
 AWG 18-22: 50N min.
 Mini:
 AWG 22: 30N min.
 AWG 24: 20N min.
 AWG 26: 8N min.
 Bottom Entry:
 AWG 18-22: 50N min.
 AWG 24: 28N min.
 Durability (min.): 25 cycles

PHYSICAL

Housing: LCP, UL 94V-0
 Contact: Copper Alloy

PLATING

Contact Area: Tin
 Solder Tail Area: Tin
 Operating Temperature:
 Mini: -40 to +130°C
 Standard/Bottom Entry: -60 to +130°C

Additional Product Features

Wire Stopper Feature For Wire Protection

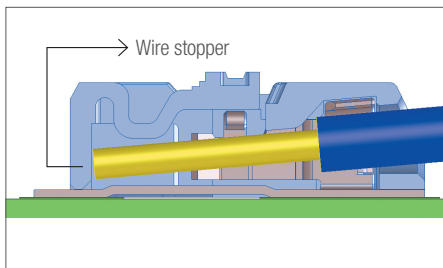

A wire stopper feature built into the mold design helps identify when the wire has been fully inserted to facilitate wire alignment and avoid wire damage

Less Shadowing With Bottom-Entry Type

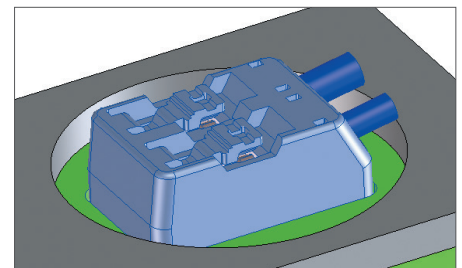
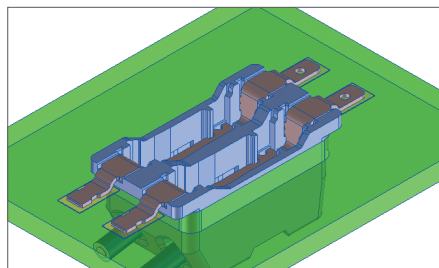

The bottom-entry type Lite-Trap™ connector (above left) has less housing material exposed above the LED panel compared to top-entry types (above right), which reduces shadowing.

Ordering Information

Type	Order No.	Circuit Size	AWG	Current
Mini	104238-0110	1	22-26 (Solid)	3.0A
	104238-0210	2		
Standard	104188-0110	1	18-24 (Solid) 20-22 (Stranded)	9.0A
	104188-0210	2		
Bottom-Entry	104266-0110	1	18-24 (Solid) 20-24 (Stranded)	9.0A
	104266-0210	2		

www.molex.com/link/litetrap.html