

### Reflow guaranteed condition

#### ● RoHS compliant

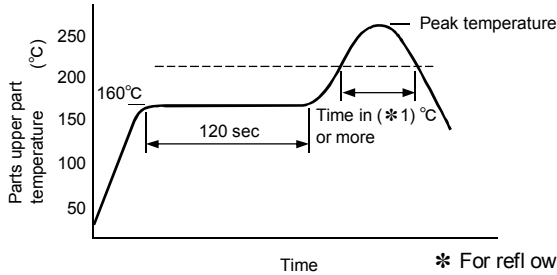

Reflow No.	Fig. (5)	Fig. (6)	
Category	$\phi 5, \phi 6.3$	$\phi 8, \phi 10$	
Peak temperature	260°C (255°C)	245°C	260°C
Time in peak temperature	$\geq 250^\circ\text{C } 5 \text{ s}$ (10 s)	$\geq 240^\circ\text{C } 10 \text{ s}$	$\geq 250^\circ\text{C } 5 \text{ s}$
Time in (*1) °C or more	$\geq 230^\circ\text{C } 30 \text{ s}$	$\geq 230^\circ\text{C } 30 \text{ s}$	$\geq 230^\circ\text{C } 30 \text{ s}$
	$\geq 217^\circ\text{C } 40 \text{ s}$	$\geq 217^\circ\text{C } 40 \text{ s}$	$\geq 217^\circ\text{C } 40 \text{ s}$
	$\geq 200^\circ\text{C } 70 \text{ s}$	$\geq 200^\circ\text{C } 70 \text{ s}$	$\geq 200^\circ\text{C } 70 \text{ s}$
Time of reflow	2 times	2 times	1 time

\* For reflow, use a thermal condition system such as infrared radiation (IR) or hot blast.  
 \* Panasonic have several series available for pure Tin terminal and ZVEI reflow based on J-STD-020D (JEDEC). (Please contact sales for details.)

### Dimensions (Vibration-proof products)

\* The size and shape are different from standard products. Please inquire details of our company.

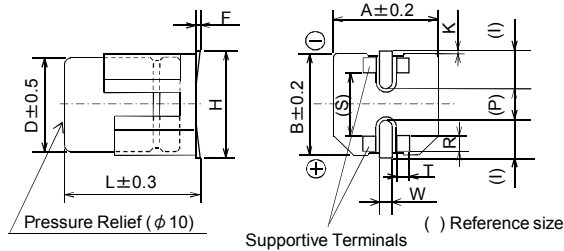

(Unit : mm)

Size code	$\phi D$	L	A, B	H max.	F	I	W
F	8.0	10.5	8.3	10.0	0 to +0.15	3.4	1.2±0.2
G	10.0	10.5	10.3	12.0	0 to +0.15	3.5	1.2±0.2

Size code	P	K	R	S	T
F	3.1	0.7±0.2	0.7±0.2	5.3±0.2	1.3±0.2
G	4.6	0.7±0.2	0.7±0.2	6.9±0.2	1.3±0.2

### Land / Pad Pattern

The circuit board land/pad pattern size for chip capacitors is specified in the following table. The land pitch influences installation strength and consider it.

Land space

#### ● Standard products

(Unit : mm)

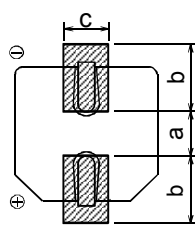

Size	a	b	c
C : $\phi 5 \times L5.8$	1.5	2.8	1.6
D : $\phi 6.3 \times L5.8$	1.8	3.2	1.6
D8 : $\phi 6.3 \times L7.7$	1.8	3.2	1.6
F : $\phi 8 \times L10.2$	3.1	4.0	2.0
G : $\phi 10 \times L10.2$	4.6	4.1	2.0

\* When size "a" is wide, back fillet can be made, decreasing fitting strength.

#### ● Vibration-proof products

(Unit : mm)

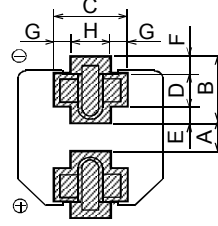

Size	A	B	C	D
F : $\phi 8 \times L10.5$	2.7	4.0	4.7	1.3
G : $\phi 10 \times L10.5$	3.9	4.4	4.7	1.3

Size	E	F	G	H
F : $\phi 8 \times L10.5$	1.0	1.7	1.1	2.5
G : $\phi 10 \times L10.5$	1.2	1.9	1.1	2.5

\* When size "A" is wide, back fillet can be made, decreasing fitting strength.

\* Take mounting conditions, solderability and fitting strength into consideration when selecting parts for your company's design.

### Packaging Specifications

#### ● Reel Dimensions in mm (not to scale)

(Unit : mm)

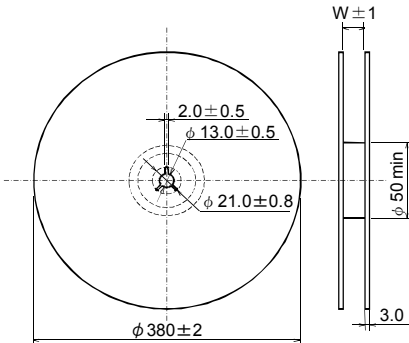

Size code	W
C	14
D, D8	18
F, G	26

#### ● Dimensions of Outer Carton Box

(Unit : mm)

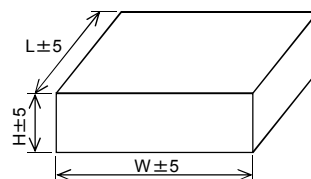

Size code	H	W, L
C	220	395
D, D8	250	395
F, G	220	395

#### ● Min. Packing Quantity

Size code	Min. Packing Q'ty pcs.
C	1000
D, D8	900
F, G	500

#### ● Taping Dimensions in mm

(Unit : mm)

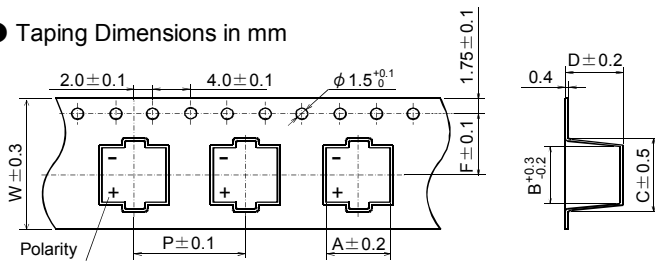

Size code	A	B	C	D	P	F	W
C	5.7	5.7	8.0	6.4	12.0	5.5	12.0
D	7.0	7.0	9.0	6.4	12.0	7.5	16.0
D8	7.0	7.0	9.0	8.4	12.0	7.5	16.0
F	8.7	8.7	12.5	11.0	16.0	11.5	24.0
G	10.7	10.7	14.5	11.0	16.0	11.5	24.0

\* Ask factory for technical specifications.