

PAGE 1/3	ISSUE 23-07-25A	SERIES SMA-COM	PART NUMBER R124076200
----------	-----------------	----------------	------------------------

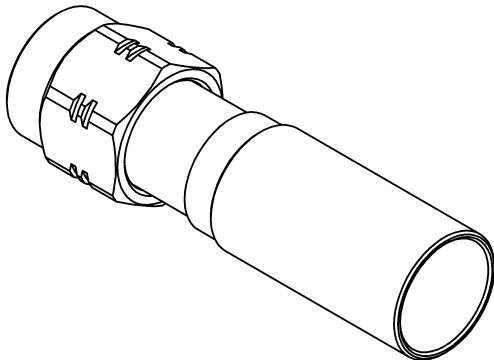

All dimensions are in mm. Tolerances according ISO 2768 m-H

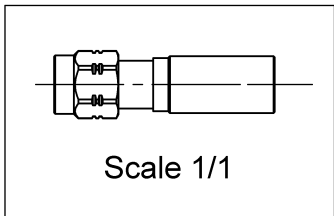
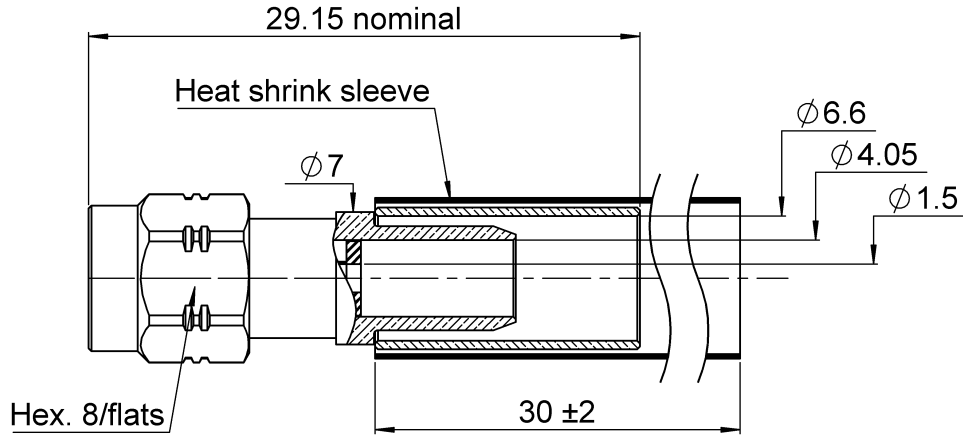
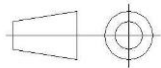

COMPONENTS	MATERIALS	PLATING (μm)
Body	BRASS	BBR
Center contact	BRASS	GOLD OVER NICKEL
Outer contact		-
Insulator	PTFE	
Gasket	SILICONE RUBBER	
Others parts	BRASS,BERYLLIUM COPPER	BBR
-	-	-
-	-	-

PAGE 2/3	ISSUE 23-07-25A	SERIES SMA-COM	PART NUMBER R124076200
-----------------	------------------------	-----------------------	-------------------------------

PACKAGING

Standard	Unit	Other
100	"W" Option	Contact us

ELECTRICAL CHARACTERISTICS

Impedance	50	Ω
Frequency	0-12.4	GHz
VSWR	1.3 * + 0	x F(GHz) Maxi
Insertion loss	0.05 *	√F(GHz) dB Maxi
RF leakage	60	- F(GHz)) dB Maxi
Voltage rating	335	Veff Maxi
Dielectric withstanding voltage	1000	Veff mini
Insulation resistance	5000	MΩ mini

MECHANICAL CHARACTERISTICS

Center contact retention		
Axial force – Mating End	NA	N mini
Axial force – Opposite end	NA	N mini
Torque	NA	N.cm mini
Recommended torque		
Mating	60	N.cm
Panel nut	NA	N.cm
Clamp nut	NA	N.cm
A/F clamp nut	0	mm
Mating life	100	Cycles mini
Nominal Weight (Add +15% for max weight)	5,47	g

ENVIRONMENTAL

Operating temperature	** -65/+165	°C
Hermetic seal	NA	Atm.cm3/s
Panel leakage	NA	

SPECIFICATION

CABLE ASSEMBLY

Stripping	a	b	c	d	e	f
mm	3.9	7,9	12.7	0	8,8	0

Assembly instruction: **SEE PAGE 3**

Recommended cable(s)

LLC 240

Characteristics indicated on this data sheet are those that can be achieved with the highest performance cable. Intrinsic limitations of the cable may diminish the performance of the assembly

Cable retention

- pull off	180	N mini
- torque	NA	N.cm

TOOLING

Hexagon	Part Number	Description
Hex 6.48 / flats (for sleeve)	R282235023	CRIMPING DIES HEX6.48 & HEX1.57
Hex 1.57/flats (for center contact)	R282293000	CRIMPING TOOL M22520/5-01

OTHER CHARACTERISTICS

* Depends on cable used

**Heat shrink sleeve temperature range -40/+125 °C

PAGE 3/3	ISSUE 23-07-25A	SERIES SMA-COM	PART NUMBER R124076200
----------	-----------------	----------------	------------------------

COMPONENTS

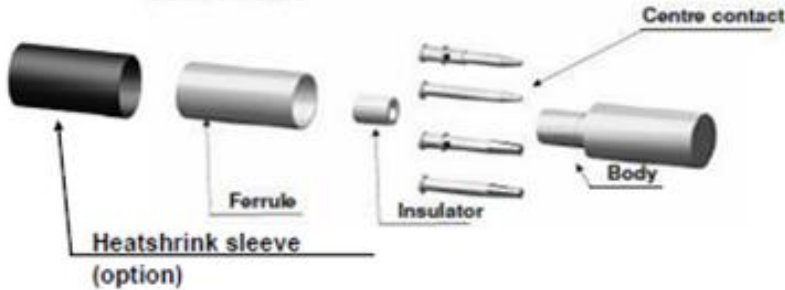

STRIPPING DIMENSIONS

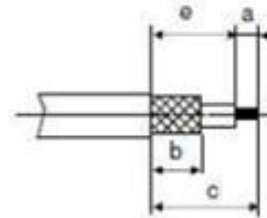

1

Slide the heatshrink sleeve onto the cable (Option).
Slide the ferrule onto the cable.
Strip the cable.

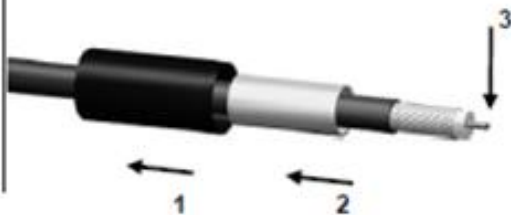

2

Slide the center contact and insulator on the cable,
Until the insulator bottom against the cable dielectric.
Crimp the center contact.



3

Fan the braid.



4

Slide the cable into the body until it bottoms against the insulator.



5

Slide the ferrule over the braid.
Crimp the ferrule with crimping tool (see connector TDS).

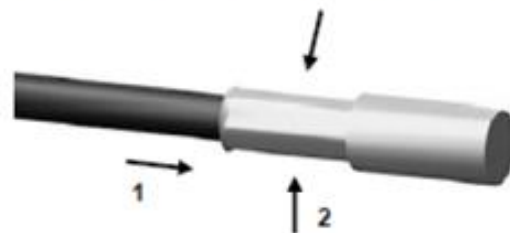

6

Cut the excess of braid if necessary.
Slide the sleeve over the ferrule and heatshrink it in place (Option).

