

PAGE 1/2	ISSUE 24-06-25A	SERIES SMA-COM	PART NUMBER R124080040
----------	--------------------	-----------------------	-------------------------------

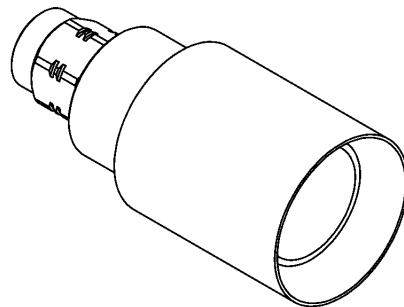

All dimensions are in mm. Tolerances according ISO 2768 m-H

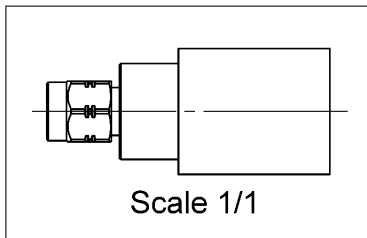
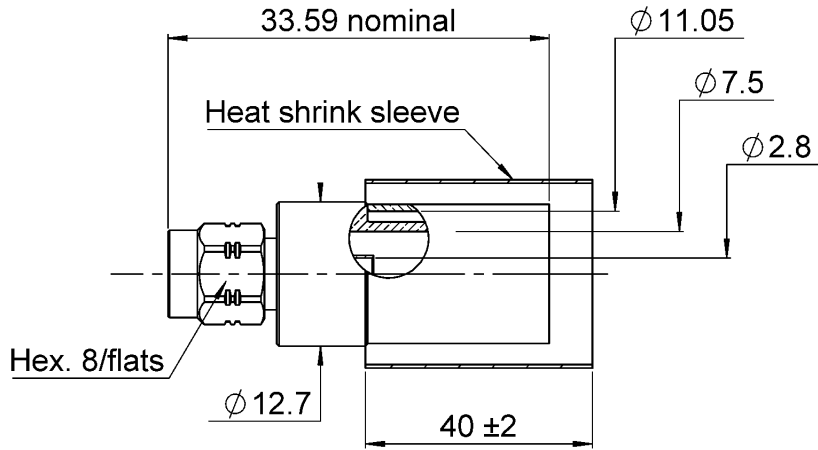
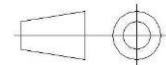

COMPONENTS	MATERIALS	PLATING (µm)
Body	BRASS	BBR
Center contact	BRASS	GOLD OVER NICKEL
Outer contact	-	-
Insulator	PTFE	
Gasket	SILICONE RUBBER	
Others parts	BERYLLIUM COPPER; BRASS	BBR
-	-	-
-	-	-

PAGE 2/2	ISSUE 24-06-25A	SERIES SMA-COM	PART NUMBER R124080040
-----------------	---------------------------	-----------------------	-------------------------------

PACKAGING

Standard	Unit	Other
100	"W" Option	Contact us

ELECTRICAL CHARACTERISTICS

Impedance		50	Ω
Frequency		0-12.4	GHz
VSWR	1.25* +	0	x F(GHz) Maxi
Insertion loss		0.05 *	√F(GHz) dB Maxi
RF leakage	- (60	- F(GHz)) dB Maxi
Voltage rating		500	Veff Maxi
Dielectric withstanding voltage		1000	Veff mini
Insulation resistance		5000	MΩ mini

MECHANICAL CHARACTERISTICS

Center contact retention			
Axial force – Mating End		NA	N mini
Axial force – Opposite end		NA	N mini
Torque		NA	N.cm mini
Recommended torque			
Mating		60	N.cm
Panel nut		NA	N.cm
Clamp nut		NA	N.cm
A/F clamp nut		0	mm
Mating life		100	Cycles mini
Nominal Weight (Add +15% for max weight)		6,33	g

ENVIRONMENTAL

Operating temperature	** -65/+165	°C
Hermetic seal	NA	Atm.cm3/s
Panel leakage	NA	

SPECIFICATION

CABLE ASSEMBLY

Stripping	a	b	c	d	e	f
mm	4,5	7	12,7	0	8.2	0

Assembly instruction: **CRIMP 02**

Recommended cable(s)
LLC 400

Characteristics indicated on this data sheet are those that can be achieved with the highest performance cable. Intrinsic limitations of the cable may diminish the performance of the assembly

Cable retention

- pull off	200	N mini
- torque	NA	N.cm

TOOLING

Hexagon	Part Number	Description
Hex 10.54/ flats(for sleeve)	R282231000	PINCE SERT HEX 10.54
Hex 10.54/ flats (for sleeve)	R282235116	MACH SERT HEX 10.54
	R282293000	CRIMPING TOOL M22520/5-01
Hex 3/ flats (for center contact)	DMC-Y152	CRIMPING TOOL M22520/5-04

OTHER CHARACTERISTICS

***0-9GHz**

****Heat shrink sleeve temperature range -55/+110 °C**

PAGE 1/2	ISSUE 24-06-25A	SERIES TNC	PART NUMBER R143089137
----------	-----------------	------------	------------------------

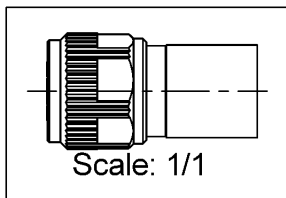
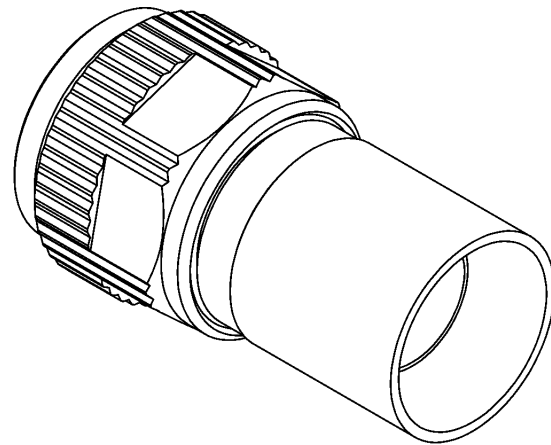
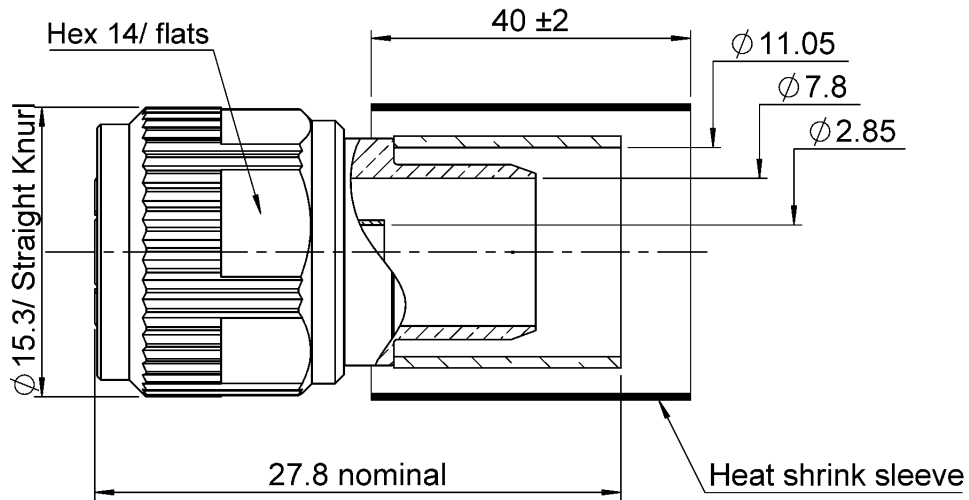

All dimensions are in mm. Tolerances according ISO 2768 m-H

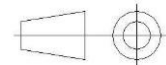

COMPONENTS	MATERIALS	PLATING (µm)
Body	BRASS.	BBR
Center contact	BRASS.	GOLD OVER NICKEL
Outer contact		
Insulator	PTFE	
Gasket	SILICONE RUBBER	
Others parts	BRASS/BRONZE	BBR
-	-	-
-	-	-

PAGE 2/2	ISSUE 24-06-25A	SERIES TNC	PART NUMBER R143089137
----------	-----------------	------------	------------------------

PACKAGING

Standard	Unit	Other
50	'W' option	Contact us

ELECTRICAL CHARACTERISTICS

Impedance	50	Ω
Frequency	0-11	GHz
VSWR	1.25* + 0.0000	x F(GHz) Maxi
Insertion loss	0.06*	√F(GHz) dB Maxi
RF leakage	-(NA	- F(GHz)) dB Maxi
Voltage rating	500	Veff Maxi
Dielectric withstanding voltage	1500	Veff mini
Insulation resistance	5000	MΩ mini

MECHANICAL CHARACTERISTICS

Center contact retention		
Axial force – Mating End	NA	N mini
Axial force – Opposite end	NA	N mini
Torque	NA	N.cm mini
Recommended torque		
Mating	NA	N.cm
Panel nut	NA	N.cm
Clamp nut	NA	N.cm
A/F clamp nut	0.0000	mm
Mating life	100	Cycles mini
Weight	14.66	g

ENVIRONMENTAL

Operating temperature	** -65/+165	°C
Hermetic seal	NA	Atm.cm3/s
Panel leakage	NA	

SPECIFICATION

CABLE ASSEMBLY

Stripping	a	b	c	d	e	f
mm	3	7.5	11.3	0	8.3	0

Assembly instruction: **Crimp 02**

Recommended cable(s)

LLC 400

Characteristics indicated on this data sheet are those that can be achieved with the highest performance cable. Intrinsic limitations of the cable may diminish the performance of the assembly

Cable retention

- pull off	200	N mini
- torque	NA	N.cm

TOOLING

Hexagon	Part Number	Description
Hex 10.54/ flats(for sleeve)	R282231000	PINCE SERT HEX 10.54
Hex 10.54/ flats (for sleeve)	R282235116	MACH SERT HEX 10.54
	R282293000	CRIMPING TOOL M22520/5-01
Hex 3/ flats (for center contact)	DMC-Y152	CRIMPING TOOL M22520/5-04

OTHER CHARACTERISTICS

*From 0-6 GHz

*Depends on cable used

**Heat Shrink Sleeve Temperature range -55/+110°C

PAGE 1/2	ISSUE 24-06-25A	SERIES TNC	PART NUMBER R143339007
----------	-----------------	------------	-------------------------------

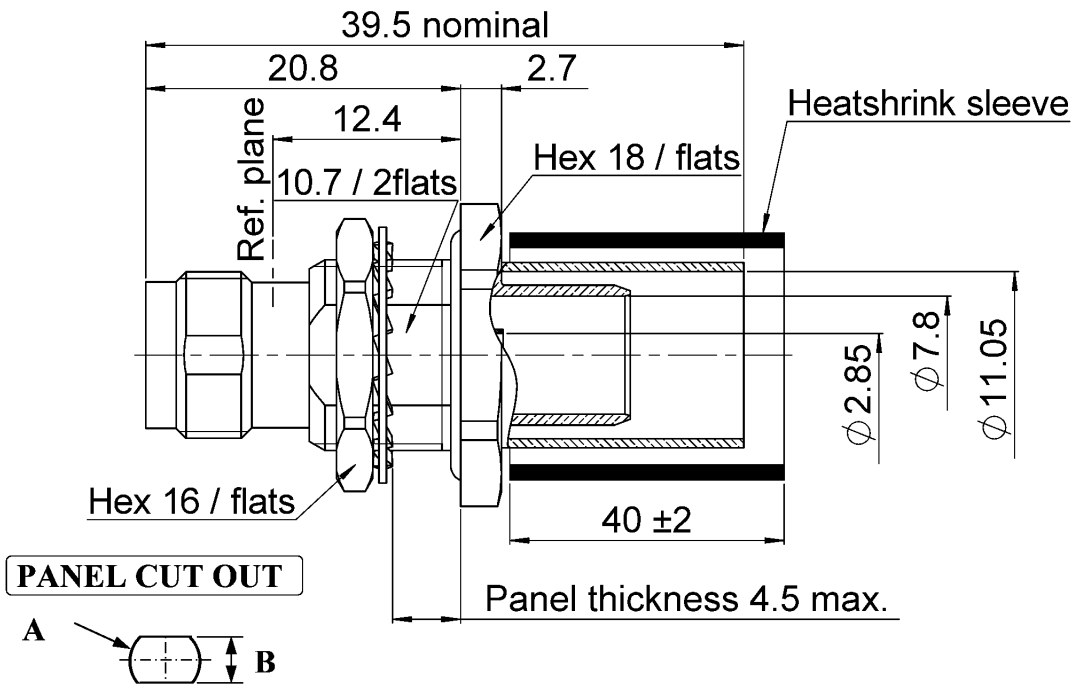

	mm	
	Maxi	mini
A	12.8	12.7
B	10.9	10.8

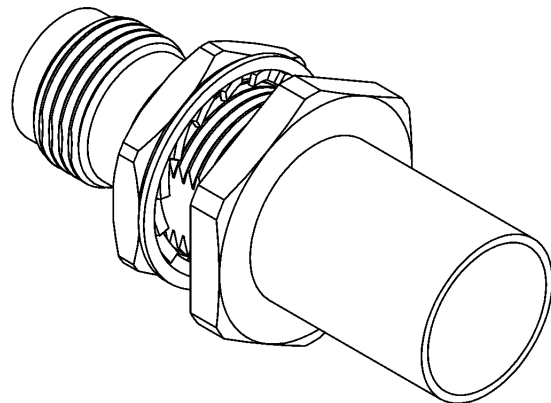
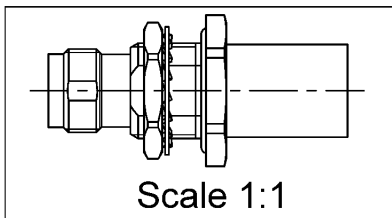

All dimensions are in mm. Tolerances according ISO 2768 m-H

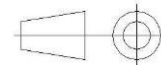

COMPONENTS	MATERIALS	PLATING (µm)
Body	BRASS.	BBR
Center contact	BERYLLIUM COPPER	GOLD OVER NICKEL
Outer contact		
Insulator	PTFE	
Gasket	SILICONE RUBBER	
Others parts	BRASS, BRONZE	BBR
-	-	-
-	-	-

PAGE 2/2	ISSUE 24-06-25A	SERIES TNC	PART NUMBER R143339007
-----------------	------------------------	-------------------	-------------------------------

PACKAGING

Standard	Unit	Other
100	'W' Option	Contact us

ELECTRICAL CHARACTERISTICS

Impedance	50	Ω
Frequency	0-11	GHz
VSWR	* 1.3 + 0.0000	x F(GHz) Maxi
Insertion loss	* 0.1	√F(GHz) dB Maxi
RF leakage	- (NA	- F(GHz)) dB Maxi
Voltage rating	500	Veff Maxi
Dielectric withstanding voltage	1500	Veff mini
Insulation resistance	5000	MΩ mini

MECHANICAL CHARACTERISTICS

Center contact retention		
Axial force – Mating End	NA	N mini
Axial force – Opposite end	NA	N mini
Torque	NA	N.cm mini
Recommended torque		
Mating	NA	N.cm
Panel nut	370	N.cm
Clamp nut	NA	N.cm
A/F clamp nut	0.0000	mm
Mating life	500	Cycles mini
Weight	8.6500	g

ENVIRONMENTAL

Operating temperature	** -65/+165	°C
Hermetic seal	NA	Atm.cm3/s
Panel leakage	IP67	

SPECIFICATION

CABLE ASSEMBLY

Stripping	a	b	c	d	e	f
mm	5	8.5	14	0	9	0

Assembly instruction: **Crimp 02**

Recommended cable(s)

LLC 400

Characteristics indicated on this data sheet are those that can be achieved with the highest performance cable. Intrinsic limitations of the cable may diminish the performance of the assembly

Cable retention

- pull off	200	N mini
- torque	NA	N.cm

TOOLING

Hexagon	Part Number	Description
Hex 10.54/ flats(for sleeve)	R282231000	PINCE SERT HEX 10.54
Hex 10.54/ flats (for sleeve)	R282235116	MACH SERT HEX 10.54
	R282293000	CRIMPING TOOL M22520/5-01
Hex 3/ flats (for center contact)	DMC-Y152	CRIMPING TOOL M22520/5-04

OTHER CHARACTERISTICS

*** From 0-6GHz**

*** Depends on cable used**

****Heat Shrink Sleeve Temperature range -55/+110°C**

PAGE 1/2	ISSUE 24-06-25A	SERIES N	PART NUMBER R161088187
----------	--------------------	----------	-------------------------------

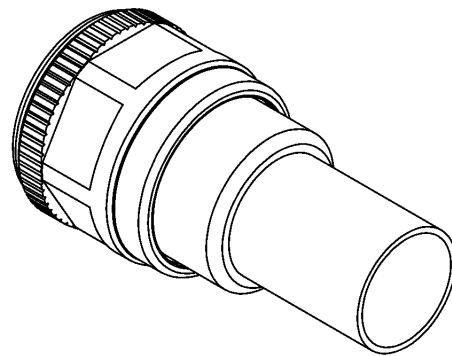
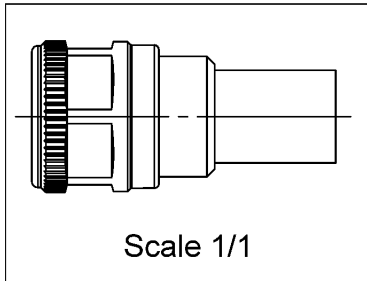
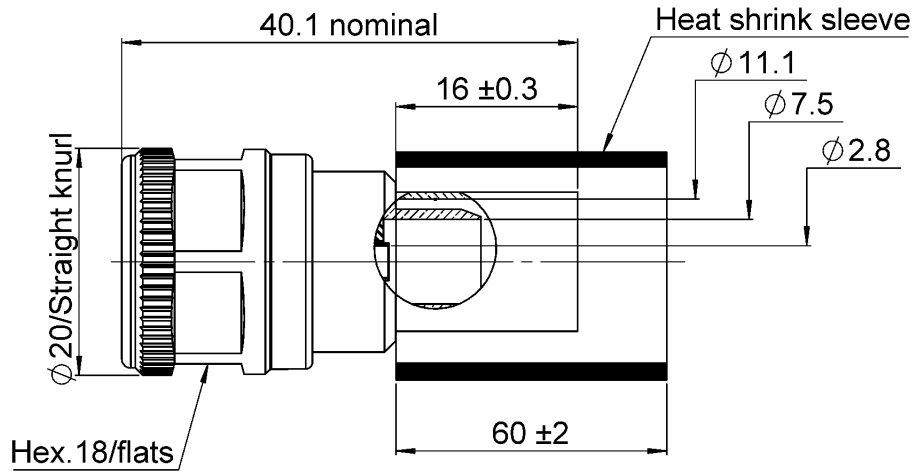

All dimensions are in mm. Tolerances according ISO 2768 m-H

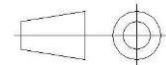

COMPONENTS	MATERIALS	PLATING (µm)
Body	BRASS	BBR
Center contact	BRASS	GOLD OVER NICKEL
Outer contact	BRASS	BBR
Insulator	PTFE	
Gasket	SILICONE RUBBER	
Others parts	BRASS	BBR
-	-	-
-	-	-

PAGE 2/2	ISSUE 24-06-25A	SERIES N	PART NUMBER R161088187
-----------------	---------------------------	-----------------	-------------------------------

PACKAGING

Standard	Unit	Other
50	"W" option	Contact us

ELECTRICAL CHARACTERISTICS

Impedance	50	Ω
Frequency	0-11	GHz
VSWR	*1.3 + 0,0000	x F(GHz) Maxi
Insertion loss	*0.048	√F(GHz) dB Maxi
RF leakage	- (101	- F(GHz)) dB Maxi
Voltage rating	1400	Veff Maxi
Dielectric withstanding voltage	2000	Veff mini
Insulation resistance	5000	MΩ mini

MECHANICAL CHARACTERISTICS

Center contact retention		
Axial force – Mating End	NA	N mini
Axial force – Opposite end	NA	N mini
Torque	NA	N.cm mini
Recommended torque		
Mating	130	N.cm
Panel nut	NA	N.cm
Clamp nut	NA	N.cm
A/F clamp nut	0,0000	mm
Mating life	500	Cycles mini
Nominal Weight (Add +15% for max weight)	33,9600	g

ENVIRONMENTAL

Operating temperature	** -55/+155	°C
Hermetic seal	NA	Atm.cm3/s
Panel leakage	NA	

SPECIFICATION

CABLE ASSEMBLY

Stripping	a	b	c	d	e	f
mm	5,0000	8,0000	14,0000	0,0000	9,0000	0,0000

Assembly instruction: **Crimp 02**

Recommended cable(s)

LLC 400

Characteristics indicated on this data sheet are those that can be achieved with the highest performance cable. Intrinsic limitations of the cable may diminish the performance of the assembly

Cable retention

- pull off	200	N mini
- torque	NA	N.cm

TOOLING

Hexagon	Part Number	Description
Hex 10.54/ flats(for sleeve)	R282231000	PINCE SERT HEX 10.54
Hex 10.54/ flats (for sleeve)	R282235116	MACH SERT HEX 10.54
	R282293000	CRIMPING TOOL M22520/5-01
Hex 3/ flats (for center contact)	DMC-Y152	CRIMPING TOOL M22520/5-04

OTHER CHARACTERISTICS

***Depends on cable used**

****Heat Shrink Sleeve Temperature range -55/+110°C**

PAGE 1/2	ISSUE 24-06-25A	SERIES N	PART NUMBER R161331067
----------	-----------------	----------	------------------------

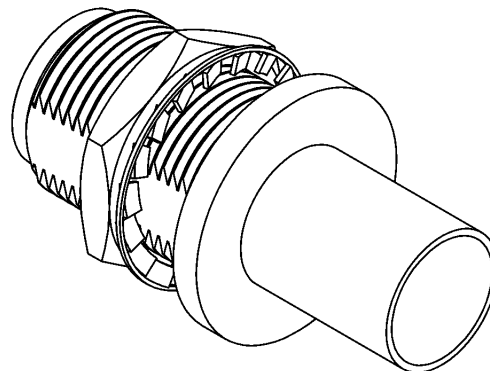
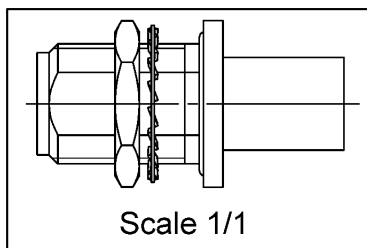
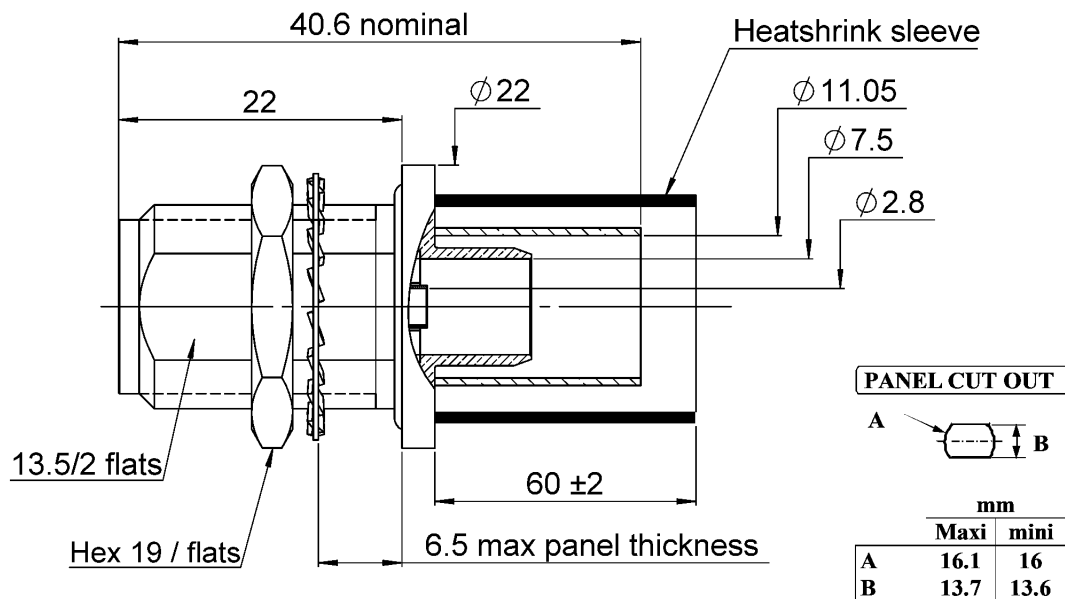

All dimensions are in mm. Tolerances according ISO 2768 m-H

COMPONENTS	MATERIALS	PLATING (µm)
Body	BRASS.	BBR
Center contact	BERYLLIUM COPPER	GOLD OVER NICKEL
Outer contact	BRASS.	BBR
Insulator	PTFE	
Gasket	SILICONE RUBBER	
Others parts	BRASS,BRONZE	BBR
-	-	-
-	-	-

PAGE 2/2	ISSUE 24-06-25A	SERIES N	PART NUMBER R161331067
----------	-----------------	----------	------------------------

PACKAGING

Standard	Unit	Other
50	'W' Option	Contact us

ELECTRICAL CHARACTERISTICS

Impedance	50	Ω
Frequency	0-11	GHz
VSWR	1.30 * + 0.0000	x F(GHz) Maxi
Insertion loss	0.048*	√F(GHz) dB Maxi
RF leakage	- (101)	- F(GHz)) dB Maxi
Voltage rating	1000	Veff Maxi
Dielectric withstanding voltage	2500	Veff mini
Insulation resistance	5000	MΩ mini

MECHANICAL CHARACTERISTICS

Center contact retention		
Axial force – Mating End	NA	N mini
Axial force – Opposite end	NA	N mini
Torque	NA	N.cm mini
Recommended torque		
Mating	NA	N.cm
Panel nut	500	N.cm
Clamp nut	NA	N.cm
A/F clamp nut	0.0000	mm
Mating life	500	Cycles mini
Nominal Weight (Add +15% for max weight)	14.8300	g

ENVIRONMENTAL

Operating temperature	-55/+110	°C
Hermetic seal	NA	Atm.cm3/s
Panel leakage	IP 67	

SPECIFICATION

CABLE ASSEMBLY

Stripping	a	b	c	d	e	f
mm	5	9	15	0	10	0

Assembly instruction: **Crimp 02**

Recommended cable(s)

LLC 400

Characteristics indicated on this data sheet are those that can be achieved with the highest performance cable. Intrinsic limitations of the cable may diminish the performance of the assembly

Cable retention

- pull off	200	N mini
- torque	NA	N.cm

TOOLING

Hexagon	Part Number	Description
Hex 10.54/ flats(for sleeve)	R282231000	PINCE SERT HEX 10.54
Hex 10.54/ flats (for sleeve)	R282235116	MACH SERT HEX 10.54
	R282293000	CRIMPING TOOL M22520/5-01
Hex 3/ flats (for center contact)	DMC-Y152	CRIMPING TOOL M22520/5-04

OTHER CHARACTERISTICS

*** Depends on cable used**